

Monitoring Relays

3UG Monitoring Relays for Electrical and Additional Measurements

3UL22 summation current transformers

Overview



The 3UL22 summation current transformers sense fault currents in machines and plants. Together with the 3UG46 24 residual-current monitoring relay or the SIMOCODE 3UF motor management and control device they enable residual-current and ground-fault monitoring.

Technical specifications

Summation current transformers				
Type		3UL22 01	3UL22 02	3UL22 03
Rated insulation voltage U_i	AC 50/60 Hz	690 V		
		1000 V		
Rated residual current $I_{\Delta n}$				
Without response delay	A	0.3 ... 1	0.3 ... 40	0.3 ... 40
Permissible ambient temperature	°C	-20 ... +70		
Feed-through openings	mm	40	65	120
For Protodur cables				
Can be fed through	Max. mm ²	4 x 95	4 x 240	8 x 300

Dimensional drawings

3UL22 summation current transformer

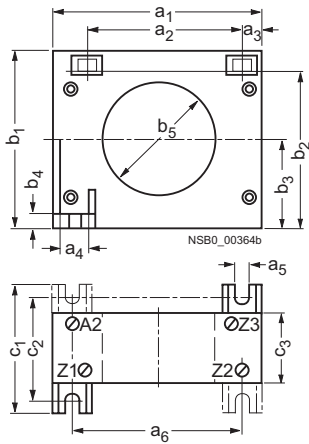

Type	a ₁	a ₂	a ₃	a ₄	a ₅	a ₆	b ₁	b ₂	b ₃	b ₄	b ₅	c ₁	c ₂	c ₃
3UL22 01	100	75	10	15	for M4	80	85	72.5	42.5	7.5	40	65	50	40
3UL22 02	125	95	10	15	for M4	100	110	97.5	55	7.5	65	70	60	45
3UL22 03	200	165	20	20	for M4	170	200	100	100	10	120	85	70	55