

Dimensional drawings

LV HRC fuse bases

Size 000/00 to 3

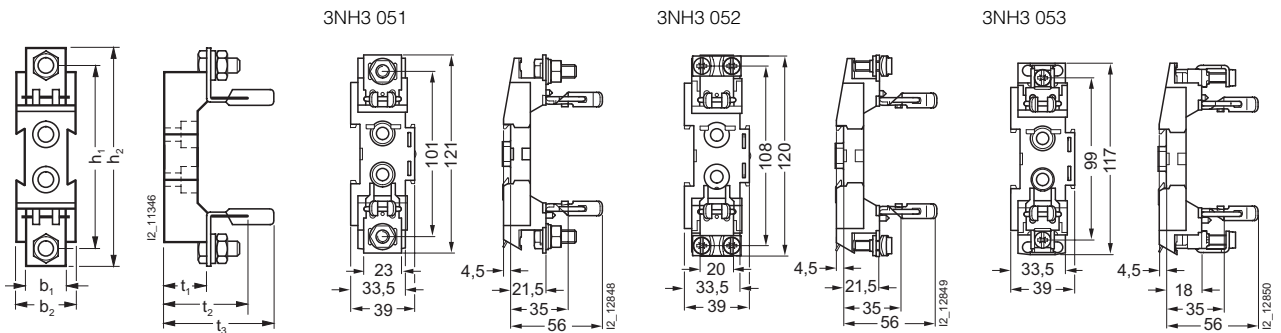

Size 4¹⁾

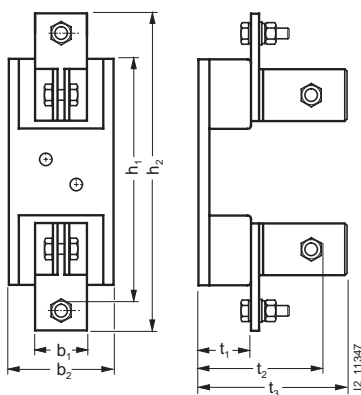

Sizes	I_n	Number of poles	Connection	Type	Dimensions						
					b_1	b_2	h_1	h_2	t_1	t_2	t_3
000/00	160	1P	M8 plug-in terminal	3NH3 0..	30	34	102	122	24	40	60
			Saddle-type terminal		29						
			Flat terminal		23						
	3P	M8 plug-in terminal	3NH4 0..	30	102	-	95	28	44	64	
		Saddle-type terminal		29							
		Flat terminal		23							
1P	Saddle-type terminal	LV HRC bus mounting base ²⁾	29	37	-	102	28	44	64		
	Terminal strip		26								
0	160	1P	Flat terminal	3NH3 1..	23	38	150	173	24	39	60
			Plug terminal		30						
1	250	1P	M10 flat terminal	3NH3 2..	35	49	177	201	35	55	84
			Double busbar terminal								
3P	250	3P	M10 flat terminal	3NH4 2..	35	49	177	201	35	55	84
			Double busbar terminal								
2	400	1P	M10 flat terminal	3NH3 3..	35	49	202	226	35	55	90
			Double busbar terminal								
3	630	1P	M12 flat terminal	3NH3 4..	35	49	212	241	35	55	101
			Double busbar terminal								
4	1250	1P	M12 flat terminal	3NH3 5..	50	102	270	max. 307	51	116 ¹⁾	144
4a	Can only be used in bases with slewing equipment										

LV HRC bus-mounting base²⁾

1P

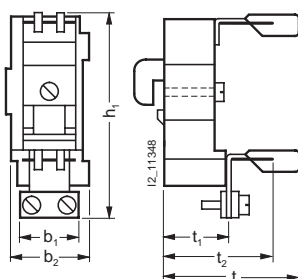

¹⁾ Size 4 LV HRC fuse links are also screwed onto the base.

²⁾ LV HRC bus-mounting bases are only connected on one side using terminals, the second connection is made through the bottom of the base.

BETA Protecting Low-Voltage Fuse Systems

LV HRC fuse bases

LV HRC bus-mounting bases in tandem design

Busbar center-to-center clearance 40 mm
3NH4 037, 3NH4 045

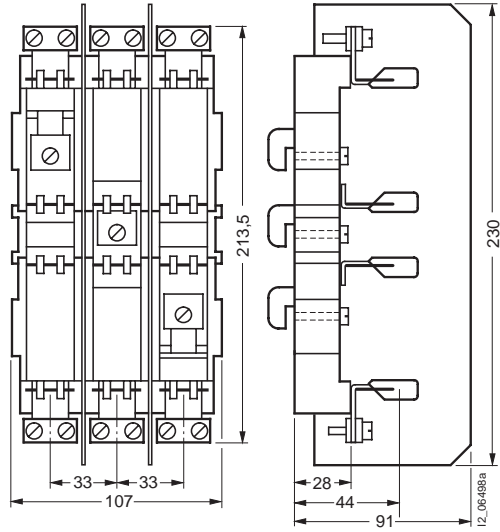

LV HRC fuse bases with slewing equipment

Sizes 000/00 to 4a

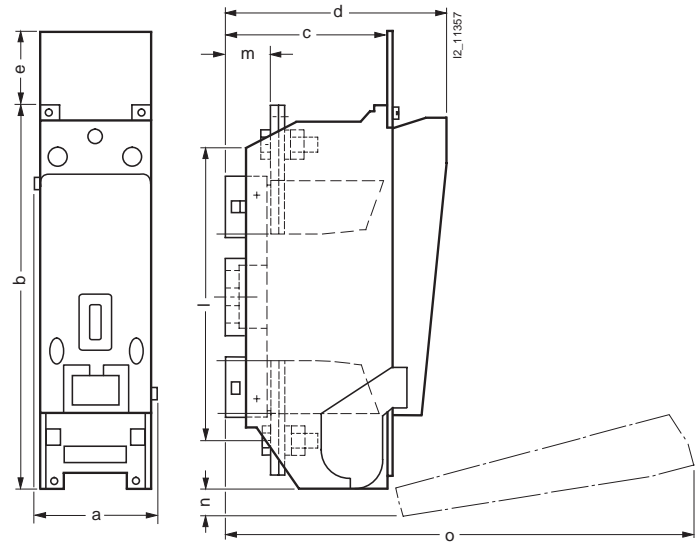

Sizes	I_n	Type	Dimensions								
	A		a	b	c	d	e	l	m	n	o
000/00	160	3NH7 03.	44	149	45	88.5	22.5	120	17	18	200
1	250	3NH7 23.	68	230	68	123.5	23	177	25	40	300
2/3	630	3NH7 33.	90	270	96	153.5	15.5	220.5	30.5	35	350
4a	1250	3NH7 520	116	350	154.5	217.5	69	270	40	26	440

LV HRC contact covers for LV HRC fuse bases

Sizes 000/00 to 3, 3NX3 10

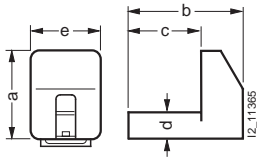

Sizes	Type	Dimensions				
		a	b	c	d	e
000/00	3NX3 105	38	47.5	34	11.5	30
1	3NX3 106	61.5	57	42.5	35	46
2	3NX3 107	74	65	51	35	46
3	3NX3 108	81.5	77.5	57.5	35	46

3NX3 115 LV HRC protective cover, with 3NX3 116 LV HRC cover

Size 000/00, degree of protection IP2X

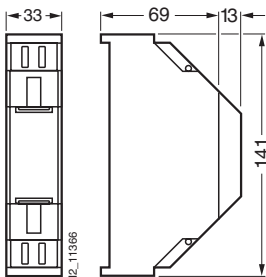

LV HRC contact covers for LV HRC bus-mounting bases

for 1-pole version and tandem design,
3NX3 105

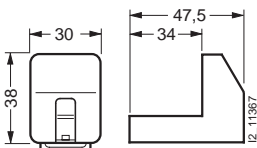

LV HRC partitions

Phase barriers
3NX2 027

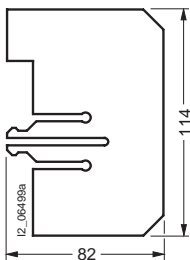

End barrier
3NX2 028

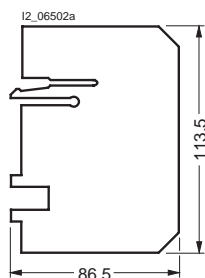

LV HRC partitions

Size 000/00
3NX3 023

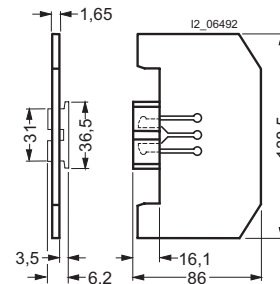

Sizes 0 to 3
3NX2 030, 3NX2 024 to 3NX2 026

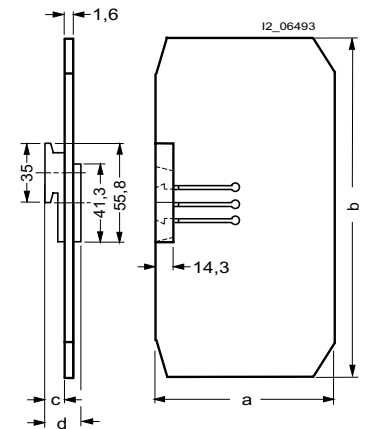

Sizes	Type	Dimensions			
		a	b	c	d
0	3NX2 030	87.6	178.5	7.7	12.3
1	3NX2 024	107.3	202.5	7.7	12.3
2	3NX2 025	115.3	227.5	14.2	25.1
3	3NX2 026	129.8	242	20.2	37.2

3P,
3NX3 113

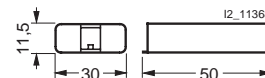

For LV HRC fuse bases in tandem design
3NX2 031

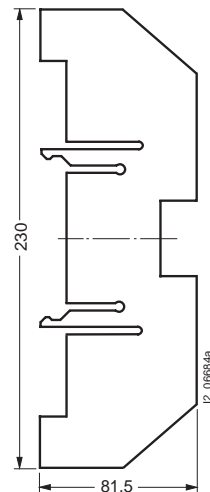

BETA Protecting Low-Voltage Fuse Systems

LV HRC fuse bases

Fuse puller

Sizes 000 to 4
3NX1 013 (without sleeve), 3NX1 014 (with sleeve)

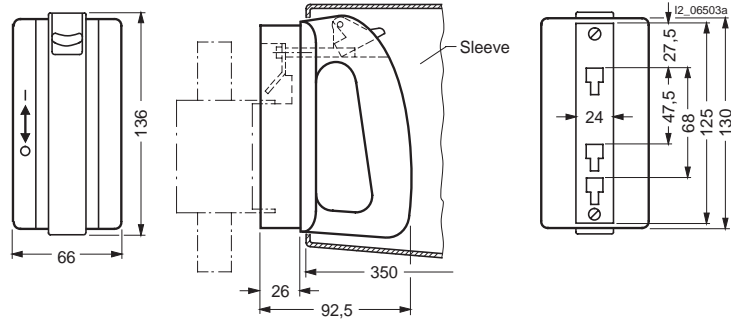

Isolating links

With insulated grip lug, sizes 000/00 to 3
3NG1.02

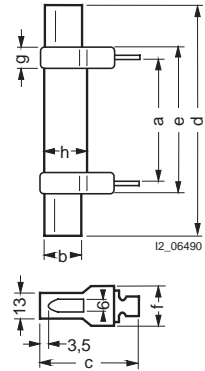

Sizes	Type	Dimensions							
		a	b	c	d	e	f	g	h
000/00	3NG1 002	44	15	48	78	54	20.5	8	19
0	3NG1 102	60.5	15	48	125	68	20.5	8	19
1	3NG1 202	61	20	53	135	72	23	9	24
2	3NG1 302	61	26	61	150	72	23	9	29
3	3NG1 402	61	32	73	150	72	23	9	36

Isolating links with non-insulated grip lugs

Size 4
3NG1 503

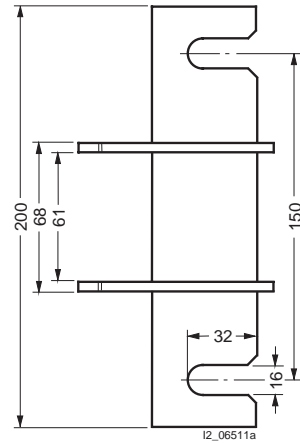

Size 4a
3NG1 505

